

## FSMB

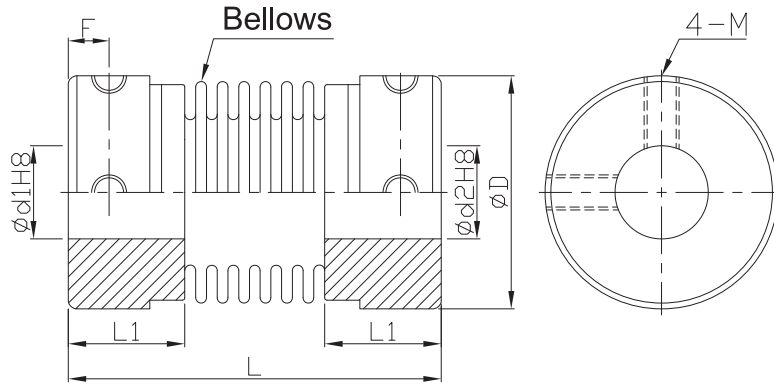

• Offset of angular, parallel, or axial deviation are individual allowed value, so couple reasons of axial offset appearing at same time would reduce the unit allowable value.



\*When  $\text{Ød1} < 4$  and  $\text{Ød2} > 5$ , there would be 3 set screws.  
 \*When  $\text{Ød1}$  and  $\text{Ød2}$  both smaller than 4, there would be 2 set screws.

Component	Material	Accessories
Main frame	SUS303	Set screw
Bellows	SUS316	

Dimensions		Ød1&Ød2 selection *Ød1 ≤ Ød2										L	L1	F	Set screw	
Model no.	ØD	3	4	5	6	6.35	8	9.525	10	12	14				M	Lock torque (N·m)
FSMB	12	•	•	•	•	•						23.5	7.5	2.5	2.5	0.5
	16		•	•	•	•	•					26.5	9	3		
	20			•	•	•	•	•	•			32	10	3.5	3	0.7
	25				•	•	•	•	•	•		36.5	12	4.5		
	32				•	•	•	•	•	•	•	42	13.5	5.5		

★ Moment of inertial torque and weight calculated by maximum diameter.

Specification		Allowable wrench torque (N·m)	Allowable misalignment			Static torsional stiffness (N·m/rad)	Max. RPM (r/min <sup>-1</sup> )	★ Moment of inertia (kg·m <sup>2</sup> )	★ Weight (g)				
Model no.	ØD		Angular (°)	Parallel (mm)	Axial (mm)								
FSMB	12	0.5	1.5	0.10	+0.4	100	32000	2.1*10 <sup>-7</sup>	9				
	16	1			-1.2					150	24000	8.0*10 <sup>-7</sup>	20
	20	1.5	2	0.15	+0.6	220	19000	2.3*10 <sup>-6</sup>	37				
	25	2			-1.8					330	15000	7.0*10 <sup>-6</sup>	73
	32	3			+0.8 -2.5								

Ordering Example: **FAMB25** - **8** - **10** - **100 PCS**  
 Model no.    Ød1    \*Ød2    Q'ty