

FAMB

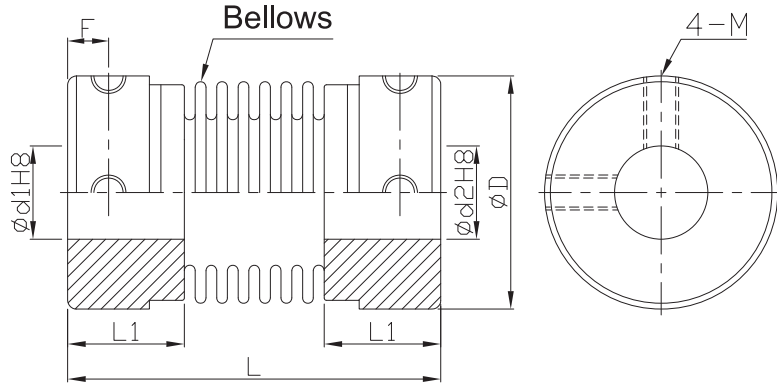

• Offset of angular, parallel, or axial deviation are individual allowed value, so couple reasons of axial offset appearing at same time would reduce the unit allowable value.



*When $\text{Ød1} < 4$ and $\text{Ød2} > 5$, there would be 3 set screws.
 *When Ød1 and Ød2 both smaller than 4, there would be 2 set screws.

Component	Material	Surface finish	Accessories
Main frame	Aluminum Alloy	Anodized	Set screw
Bellows	C5191	—	

Model no.	ØD	Ød1&Ød2 selection *Ød1 ≤ Ød2										L	L1	F	Set screw	
		3	4	5	6	6.35	8	9.525	10	12	14				M	Lock torque (N·m)
FAMB	12	●	●	●	●	●						23.5	7.5	2.5	2.5	0.5
	16		●	●	●	●	●					26.5	9	3		
	20			●	●	●	●	●	●			32	10	3.5	3	0.7
	25				●	●	●	●	●	●		36.5	12	4.5		
	32				●	●	●	●	●	●	●	42	13.5	5.5		

★ Moment of inertial torque and weight calculated by maximum diameter.

Model no.	ØD	Allowable wrench torque (N·m)	Allowable misalignment			Static torsional stiffness (N·m/rad)	Max. RPM (r/min ⁻¹)	★ Moment of inertia (kg·m ²)	★ Weight (g)				
			Angular (°)	Parallel (mm)	Axial (mm)								
FAMB	12	0.3	1.5	0.10	+0.4	82	32000	9.0*10 ⁻⁸	4				
	16	0.5			-1.2					110	24000	3.5*10 ⁻⁷	9
	20	0.8	2	0.15	+0.6	180	19000	9.9*10 ⁻⁷	16				
	25	1.3			-1.8					240	15000	3.1*10 ⁻⁶	32
	32	2			+0.8 -2.5								

Ordering Example: **FAMB20** - **6** - **8** - **100 PCS**
 Model no. | Ød1 | Ød2 | Q'ty